

16" BUTTERFLY VALVE VAULT PIPING PLAN

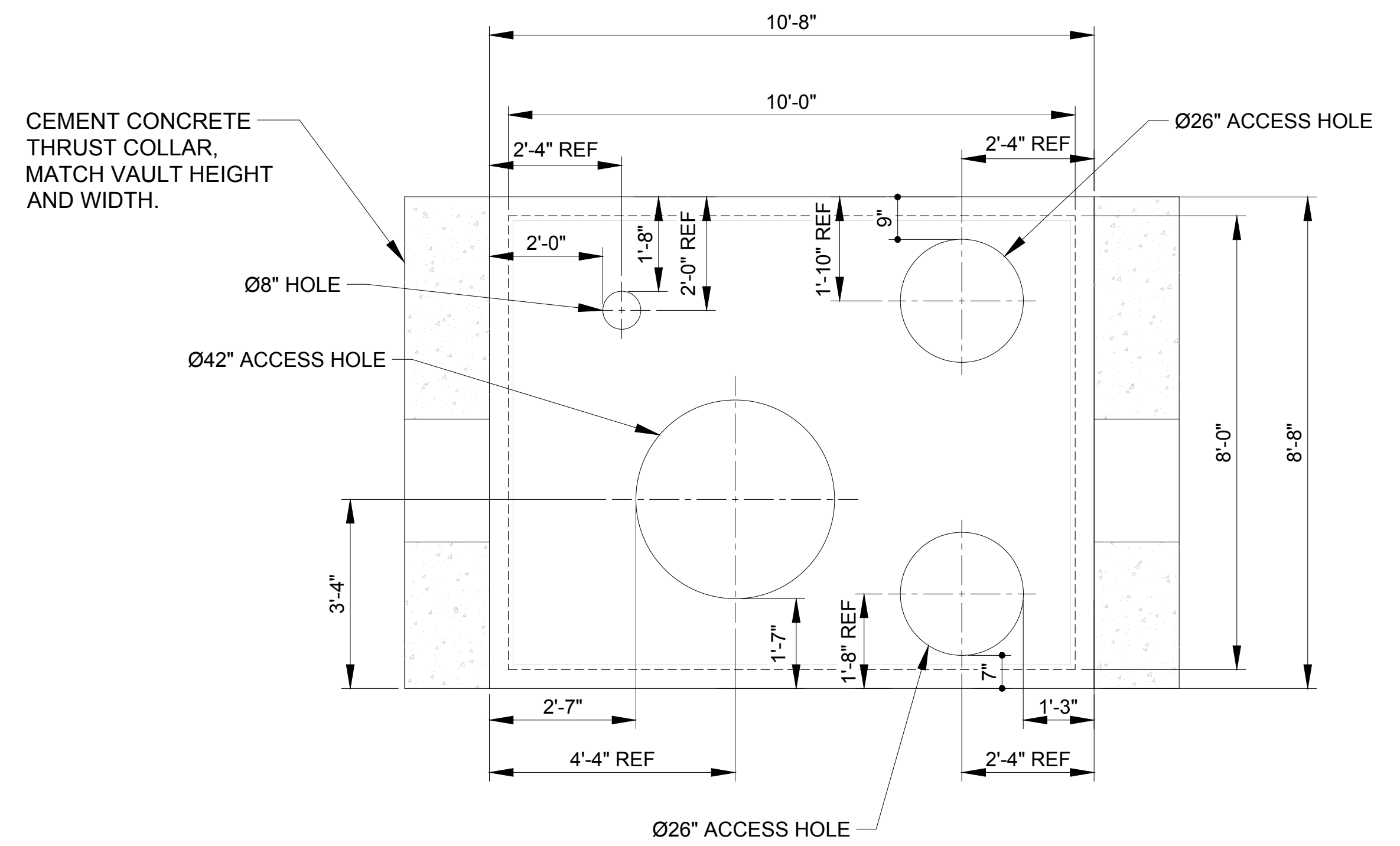

16" BUTTERFLY VALVE VAULT PLAN

BILL OF MATERIALS

4" & 16" BUTTERFLY VALVE VAULT

TAG #	QTY	SIZE	DESCRIPTION	ACTUAL LENGTH	NOTES
A01	1	16"	ERDIP JOINT X FLG PIPE - CL52 / CL / PC	5'- 2"	
A02	4	16"	MID SPAN RESTRAINT (SERIES 1100)		
A03	1	16" X 4"	FLG TEE - C110 / CL / PC	CC = 15.00" X 15.00"	
A04	1	16"	FLG X FLG PIPE - CL53 / CL / PC	1'- 8 3/4"	
A05	1	16"	ROMAC DJ400 DISMANTLING JOINT, FLG X FLG WITH CONTROL RODS	LL = 18.50"	
A06	1	16"	FLG BUTTERFLY VALVE AWWA C504 W/ OPERATING NUT, EXTENSION STEM	LL = 8.00"	
A07	1	16"	ERDIP JOINT X FLG PIPE - CL52 / CL / PC	5'- 2"	
A08	2	4"	FLG X PE PIPE - CL53 / CL / PC	1'- 5 5/8"	
A09	2	4"	FLG X MJ GATE VALVE AWWA C509 W/ OPERATING NUT, EXTENSION STEM	LL = 8.00"	
A10	2	4"	FLG X MJ 90 DEGREE BEND - C110 / CL / PC	CC = 0'- 6 1/2" X 0'- 6 1/2"	
A11	1	4"	PE X PE PIPE - CL52 / CL / AC	2'- 3 3/8"	
A12	1	4"	MJ TEE - C110 / CL / PC	CC = 0'- 6 1/2" X 0'- 6 1/2"	
A13	1	4"	PE X PE PIPE - CL52 / CL / AC	2'- 0 1/4"	

A14	6	16"	150LB HDG A307A BOLT KIT 12EA 1" X 4-1/2" B&N		
A15	6	16"	150LB FULL FACE, 1/8" THICK GASKET		
A16	4	4"	150LB HDG BOLT KIT ASTM A307A BOLTS, 8EA 5/8" X 3" BOLT WITH NUT		
A17	4	4"	150LB FULL FACE, 1/8" THICK GASKET		
A18	7	4"	1400 RESTRAINT FOR DI W/316SS/USA/ACC		

STD ABBREVIATIONS & NOTES LEGEND

01. COATING AND LINING.

LINING	COATING
CEMENT LINING (CL)	PRIME COAT (PC)

02. MJ = MECHANICAL JOINT

03. FLG = FLANGE JOINT

04. PE = PLAIN END

05. LL = LAY LENGTH

06. CC = CENTER TO CENTER

07. CL52 / 53 = THICKNESS CLASS 52/53

OWNER:- ENGINEER:-

DISCLAIMER

RJ Barnes and Associates has prepared these layout drawings and material lists in accordance with our interpretation of the project drawings and specifications that were provided. Approval of these drawings and material lists constitute acceptance of our interpretation of material requirements for the subject job. Please check the drawings and material lists carefully to insure they are correct for your project.

If corrections need to be made, please mark one set of the drawings in a contrasting color and return them to this office with your comments. No material shown in these drawings should be released for manufacture without written approval from the end customer.

REV	DRAWING REVISED AS PER COMMENTS	ST	RJB	01/20/2025
	PARTICULARS	BY	APP'D	DATE

R. J. Barnes & Associates, 1442 S 500 E - STE 300, American Fork, UT 84003